

The SECOND DOG WATCH

SAN DIEGO SHIP MODELERS GUILD
NEWSLETTER

OCTOBER 2024

32° 43'N



117° 10'W

Vol LII, No 10

GUILD OFFICERS

[John Walsh](#)

Guild Master

[Tom Hairston](#)

First Mate

[Isaac Wills](#)

Purser

[Karl Zingheim](#)

Log Keeper

[Alex Roel](#)

Newsletter Editor

COMMITTEE CHAIRS

[John Walsh](#)

Web Master

[Chris Sullivan](#)

Photographer

[John Walsh](#)

Presentations

[Jon Sanford](#)

Model Shop

[Isaac Wills](#)

Youth Coordinator

[Steve Scheet](#)

Fair Coordinator

[John Walsh](#)

Community Build

NEWSLETTER

/'nu:zletər/

One of the first things I did upon election to Newsletter Editor was revisit a few dozen of our past issues in our [Newsletter Archive](#) in order to remind myself how our Newsletter has evolved.

I then decided to survey the newsletters of other model shipcrafting groups. Happily, I found that most of the 18 groups with which we regularly correspond maintain a newsletter archive of some sort on their respective websites. This made it easy to browse through a myriad of layouts, styles, articles, features, and logs as I prepared to publish my first issue.

Along the way I noticed that 15 of the 18 organizations had given their newsletter a distinctive name. Curiously, the three outliers were all from Southern California: our Guild, the Ship Modelers Association, and the San Diego Argonauts. I tucked this bit of information away as something of passing interest.

However... as the months went by an elusive but persistent idea for a newsletter name began to rise to the surface as I edited each succeeding issue.

I often note in the *Last Meeting* section that “the meeting started on time at 6pm, or 4 bells.” That was the genesis of the idea for a name. A few issues later it occurred to me that 4 bells at 6pm *also* marks the start of the second dog watch — and the idea began to solidify. Sharing this observation with Guild Master John Walsh one day elicited his response that “our meetings are [also] scheduled for two hours, like a dog watch.”

A name was born.

Welcome to ***The Second Dog Watch***

Alex



MMSD Supporter

San Diego Ship Modelers Guild
1492 North Harbor Drive, San Diego CA, USA 92101
sdshipmodelersguild.org

established 1971 by Bob Wright and Russ Merrill



NRG Chapter Club

So, how about that? Our (not so) little newsletter has a name!

I'll admit that when Alex sent me the draft of this month's edition, I had forgotten that hypothetical discussion about naming our monthly missive, and was pleasantly surprised to see that he had followed through with his idea after giving it much consideration.

It's something new! It's something different! That could be scary! Change often is. What if they hate it? What if they hate me? All the age-old fears come out of the woodwork to plague us at the start of every endeavor, no matter what it is.



In This Issue

- ☑ [Newsletter](#)
- 🚢 [From the Quarterdeck](#)
- 🔧 [On My Workbench](#)
- 🚢 [A Sea Shanty](#)
- 🔔 [Last Meeting](#)
- 🔔 [Show and Tell](#)
- 🚢 [Flotsam and Jetsam](#)
- 🚢 [Roll Call](#)
- 📖 [Tales of the FLY: A Study](#)
- 🚢 [Resources](#)
- 🚢 [Home Port](#)
- 🚢 [The Bitter End](#)

I know that's how I felt when I was first asked to consider the possibility of becoming the Guild Master. I was too young. Too new. Not good enough of a modeler. I'm thankful I put all of those anxieties aside and sailed forth anyway.

After nineteen months in the role I can confidently equate being the Guild Master to any ship modeling project. There are periods of great concentration, flashes of frustration, moments of zen, collaborators willing to help, and eventually a euphoria of accomplishment.

The result is unlikely to be perfect, but there's no harbor for regret, either. In a word: worthwhile.

Our Guild is meant to change, adapt, grow. That's why the Bylaws only allow a Member to hold the position of Guild Master for a maximum of two consecutive years. It's to keep things fresh, to allow for new perspectives, to keep us moving forward rather than stagnating.

Rather than waiting until the month before elections to start this conversation, I am initiating it now. If you have even the smallest inkling of a notion of a desire to take the helm of our Guild, this is the time to make that known. Let's not wait until the final days of my tenure to begin a transfer of knowledge. Far better there's time to prepare than to hope that a mad-dash toss of the baton is good enough.

Our Guild is a ship, we're sailing full and by, and the crew needs one of our own to step forth onto this quarterdeck and take the helm from me. Who among you is willing to answer that call before eight bells ends my watch?

Fair winds and following seas,
John Walsh, Guild Master

 OFFICIAL BALLOT — Officers			
Position	Nominee	AYE	NAY
Guild Master			
First Mate			
Log Keeper			
Purser			
Newsletter Editor			

SAMPLE



I currently have FRAM, the pride of Norway, a Norwegian Arctic and Antarctic explorer from the 1890's on my workbench.

The Museum

I first became acquainted with FRAM when my wife and I saw her at the [FRAM Polar Exploration Museum](#) in Oslo three years ago. The museum is excellent, and is situated on a peninsula along with the KON-TIKI Museum and the Norwegian Maritime Museum among others.

The Kit

I had been searching far and wide for a model to build, and a very good Norwegian friend of mine obtained a FRAM kit for me (the kit is a bit elusive to procure: it may only be available at the Museum and then on a very limited basis.)

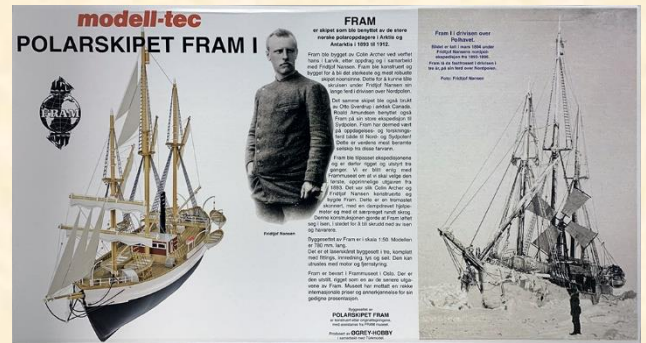

The Build

The kit is precisely made, and is a real pleasure to build. Nearly 36" in length, the quality is superb; so well made it nearly "snaps" together. The wood parts are very accurately laser cut; however, the hardware is a brittle resin product that easily breaks that has compelled me to scratch build a few replacement items.

As you can see, I am well along on FRAM, having completed the hull and deck planking.



This is the first model I have painted, and I commend the kit's excellent paint chart and am pleased with how well the painting came out.

Next up for me: masting and rigging.

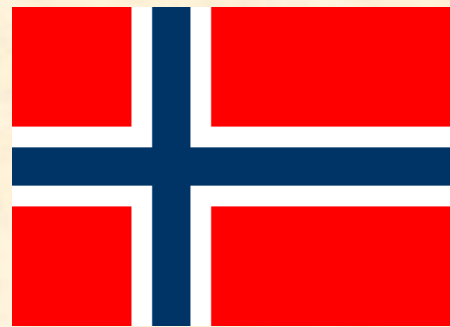

- *FRAM by Mike Hite*
- *modell-tec kit, wood, resin*
- *1/4"≈1' 1:50, under construction*

Roll The Old Chariot Along

Listen to it on  YouTube

Oh, we'd be alright if the wind was in our sails
Oh, we'd be alright if the wind was in our sails
Oh, we'd be alright if the wind was in our sails
And we'll all hang on behind

And we'll roll the old chariot along
We'll roll the old chariot along
We'll roll the old chariot along
And we'll all hang on behind

Oh, we'd be alright if we make it 'round the Horn
We'd be alright if we make it 'round the Horn
We'd be alright if we make it 'round the Horn
And we'll all hang on behind

CHORUS

Well, a nice watch below wouldn't do us any harm
Well, a nice watch below wouldn't do us any harm
Well, a nice watch below wouldn't do us any harm
And we'll all hang on behind

CHORUS

Well, a night on the town wouldn't do us any harm
Well, a night on the town wouldn't do us any harm
Well, a night on the town wouldn't do us any harm
And we'll all hang on behind

CHORUS

Well, a drop of Nelson's blood wouldn't do us any harm
Well, a drop of Nelson's blood wouldn't do us any harm
Well, a drop of Nelson's blood wouldn't do us any harm
And we'll all hang on behind

CHORUS



Last Meeting *photography by Chris Sullivan*



Editor's Note: Special thanks to Log Keeper Karl Zingheim and Member Chuck Seiler for providing the following summary of meeting events in the absence of the Newsletter Editor.



The Guild's September meeting was attended by 18 Members¹ and 3 guests²; all Officers except the Newsletter Editor were present. 1 new Member³ joined the Guild.



The meeting was brought to order by Powder Monkey Karl Zingheim who struck four bells at 6:00pm to signal the start of ***the second dog watch***.



Guild Master John Walsh opened the meeting by introducing guests Niko Hua, Elizabeth Hua, and Patrick Williams. Niko is 10 years old and extremely interested in ship design. His mother Elizabeth was searching for introductory engineering classes when her inquiry led her to the Maritime Museum of San Diego. Upon hearing this, Guild Master John Walsh and Youth Coordinator Isaac Wills reached out to Elizabeth to share information about our Guild. We're thankful to her and Patrick for encouraging Niko's interests!



John also introduced new Member Bill Fisher, who was part of the San Salvador build crew. Welcome aboard, Bill!



John then opened the business portion of the meeting by announcing that Community Build IV had just completed its' first meeting immediately prior to the night's Guild meeting.



John alerted the Members that because of a conflicting event the December Guild meeting will take place on Monday, December 9th, at the usual start time. ***This is a one-time schedule adjustment.*** 



Purser Isaac Wills reported that the transfer of banking authority continues apace and he has now opened a new account and that the Guild holds a positive balance.

¹ Clausson, Dressel, Hairston, Hite, Lonneckner, López de Arenosa, Miller, Sanford, Seiler, Sellen, Sullivan, Thompson, Walsh, Wills, Yotter, Yumoto, Zamora, Zingheim

² Niko Hua, Elizabeth Hua, Patrick Williams

³ Fisher

First Mate Tom Hairston announced that he has delivered 220 completed Mini-STAR kits to the Museum Model Shop. In other words, the Guild is already prepping for the 2025 San Diego County Fair. Thank you Tom!

Several Members including Don Dressel, Chuck Seiler, and Steve Miller responded to last month's call for new "Cool Tools" to be featured in upcoming Newsletters.

John donned his Web Master cap and announced that the Member Roster (available via the Website's "[Sea Locker](#)") is now a live Google document; you may access Member roster, phone and email information as previously.

Finally, John also reminded the Members that [Guild Bylaws](#) place a definitive term limit of two years on the Guild Master's tenure and that the next election in March will require new nominees for this leadership position.

Business concluded, a refreshment break was called.

Upon reconvening, John shifted the meeting's focus to a somewhat short and sweet [Show and Tell](#), after which the Powder Monkey rang the bell at 7:30pm to close out the September meeting.

Flotsam and Jetsam

Flotsam is defined as debris that unintentionally goes overboard, possibly due to weather conditions or accident.



Jetsam is defined as debris gone overboard purposely, most often to lighten the vessel's weight or as an overt act of dumping or littering.



Editor's Note: Special thanks to Log Keeper Karl Zingheim for providing the following details of Show and Tell in the absence of the Newsletter Editor.



- **CONSTITUTION** by Douglas Yumoto
- Woodrafter kit, solid hull, wood, glass, paper
- unknown scale, not started



Douglas Yumoto displayed a ship-in-a-bottle kit of the CONSTITUTION he recently purchased at Discount Hobby Warehouse in Kearny Mesa and is contemplating producing his first ship-in-a-bottle project .

Isaac Wills brought in a blueprint of the UNITED STATES to lament the imminent removal of the venerable ocean liner from her berth in Philadelphia due to a rent dispute and her planned disposition as an artificial reef off Destin, Florida.

- **UNITED STATES** by Isaac Wills
- blueprints
- unknown scale



Steve Miller exhibited the latest progress with his PRINCE DE NEUFCHATEL build which has now advanced to the transom.

- *PRINCE DE NEUFCHATEL* by Steve Miller
- Constructo kit, plank-on-bulkhead, wood
- 13/64" ≈ 1' 1:58, under construction



His first go with the transom resulted in a setback, so he made a template out of the official drawings and produced a much more satisfactory stern.

With the addition of quarter gun ports, and (still more) adjusting of the bowsprit rake Steve is nearer to moving on to the masts and rigging.

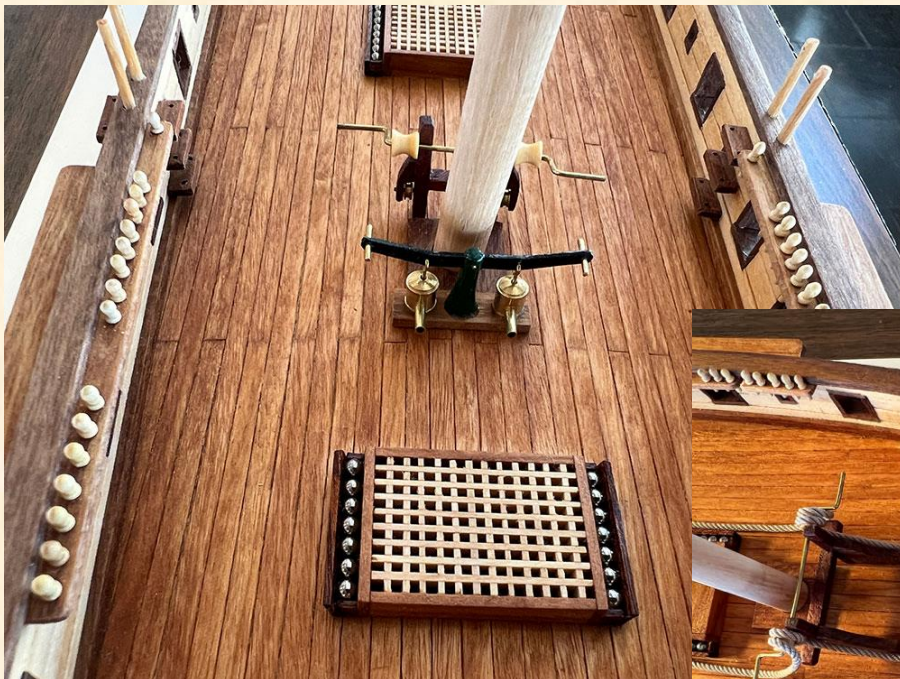

🚢 Flotsam and Jetsam

“Don't give up the ship!”

Captain James Lawrence, USS CHESAPEAKE, 1813

Soundings – pronouncing nautical terms

The **FORECASTLE** is the upper superstructure located just aft of the bow of a ship. Originally a battle platform (thus “castle”) and then simply used as a storage and gathering place, over time both its’ use and pronunciation has changed; make sure you’re using the right one.

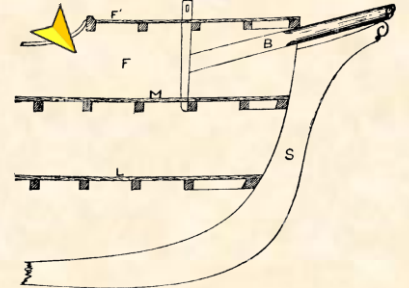

Reads like: **fore•cass•ul** (one word, three syllables, accent on first)

Pronounced: **foke•sul** (one word, two syllables, accent on first)

Museum Model Shop – utilize, support, volunteer

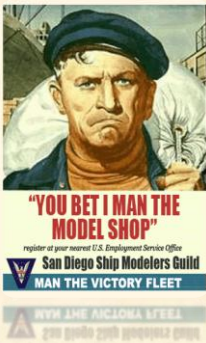

All Guild Members are welcome to work in the Museum Model Shop aboard the BERKELEY. Besides having five dedicated work stations, the Model Shop is also the home to the Guild’s model shipcrafting library, tools, and a large inventory of building supplies. By volunteering time in the Model Shop our presence benefits the MMSD by affording their patrons the opportunity to see our craft in action and up close. Contact Model Shop Chair [Jon Sanford](#) for more information on how you can participate.

Around the Scuttlebutt – latest Guild news



Community Build IV is now underway. Twelve Members attended the initial meeting aboard the BERKELEY. Chuck Seiler reports that “the first meeting demonstrated a wide variety of completion. Hopefully the experience of those who are further along will help those that are not...” Cryptically, Chuck went on to say “And remember, all the answers are on page 78” (which turns out to be a missing page in the kit’s instructions.)

- ☕ The focus of this Community Build is the NRG’s [“Masting and Rigging Project”](#) kit.
- ☕ The group meets aboard the BERKELEY at 3pm the same day of each regularly scheduled monthly Guild meeting; contact Community Build Chairman [John Walsh](#) if interested.



Member Chari Wessel relays that former Guild Member and long-time Newsletter Editor Katherine Pogue is now Captain of the 210-ton brig LADY WASHINGTON berthed at Gray's Harbor Historical Seaport in Aberdeen, Washington.

[Learn more about Katherine, her crew, the museum, and the LADY WASHINGTON.](#)



[Our Guild is featured in a recent video](#)

produced by the Association of Professional Model Makers (APMM) about the Maritime Museum of San Diego's model collection and the model makers (us) of the Guild. MMSD's Collection Manager (and Guild Member) Kevin Sheehan hosts the video and describes the Museum's assets and association with our Guild. Kevin then hands off the narrative to Guild Master John Walsh and Purser Isaac Wills who discuss model making while working in the Museum Model Shop.



Due to a scheduling conflict with the MMSD, the **DECEMBER** meetings (both Guild and Community Build) will be held on **MONDAY, DECEMBER 9th** aboard the BERKELEY instead of Tuesday, December 10th. 

On The Horizon

OCT 1	6pm	Officers Meeting	online
OCT 8	3pm	Community Build Meeting	BERKELEY
OCT 8	6pm	Guild Meeting	BERKELEY
OCT 29	–	Newsletter	Website, email
NOV 5	6pm	Officers Meeting	online
NOV 12	3pm	Community Build Meeting	BERKELEY
NOV 12	6pm	Guild Meeting	BERKELEY
NOV 26	–	Newsletter	Website, email

How did you come to call San Diego home?

I traveled to the United States from Spain quite a lot over the years and I eventually married a California girl. During my travels here San Diego became my favorite city: I loved the maritime environment, the beaches, and the weather. When I retired my wife wanted to come back to the States to work, and, as we both loved San Diego, she got a job teaching at the University of San Diego and I started my new retired life.

Tell us a bit about your life/career path.



I am from Spain, and worked as a police officer for 42 years, starting as an Inspector and finishing as Superintendent. During those years I worked as a diplomat, representing the Spanish Ministry of Home Affairs at Spanish Embassies in London (12 years) and Pakistan (4 years, with duty also in Iran and Afghanistan.) I also worked in Brussels in the Intelligence Unit of the EEAS (European External Action service.)



How did you come to the Guild?

When we moved to San Diego I visited the Maritime Museum of San Diego where I found information about the Guild and thought that it was a great opportunity to meet American modelers. I had never been a part of any modeler's association before. For me this was something new, and as I was starting a new life anyway, I sent in the application.

Do you recall your first model?

I made lots of plastic models (ships, tanks, airplanes) with other friends in Madrid when I was a teenager. At that time models available in Spain were quite limited: this was the 1970s with Francisco Franco at the helm. The only brands available in shops were British (Airfix), French (Heller) and American (Revell); later the Japanese arrived in force with Tamiya. My first sailing ships were a plastic model of CUTTY SARK (I don't remember the brand) and a Revell plastic model of CHARLES W MORGAN. Unfortunately, as I moved over the years my old models

disappeared into thin air. However, my wife gave me a model ship kit to keep me busy during convalescence after I was in a car accident where I broke two vertebrae in my neck and had a cast from neck to chest for 6 months. It was Artesania Latina's CHARLES W MORGAN, my first wooden model.

Of the models you've made, which is your favorite?

My favorite is the American whaler CHARLES W MORGAN that my wife gave me. I've also built Joshua Slocum's SPRAY (he's a distant relative of hers,) the Artesania Latina kits HARVEY and SAN FRANCISCO, and the Dikar model of the bomb vessel LA CANDELARIA. I've also made several smaller models: the American Revolution brig WASP, a Baltimore Clipper and a Cuban mail ship. Currently I'm working on the FAIR AMERICAN by Model Shipways.

Describe another avocation you enjoy.

I enjoy reading in general but particularly about ship modeling (mainly history, maritime issues, and novels.) Finally, my other passion is visiting maritime museums when I travel: I have visited many in both the States and Europe.

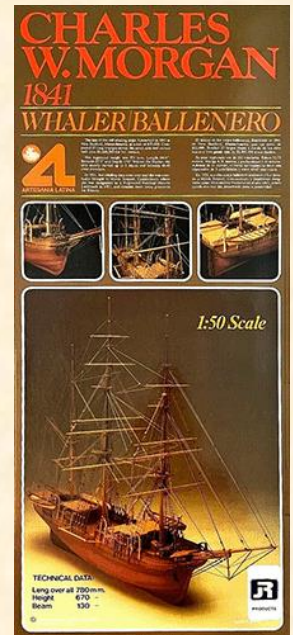



In [Part Three](#) I discussed building the hawse timbers... now we move on to getting the keel ready to accept the angled cant frames.

Preparing the Keel

Next, the keel was prepared to accept the cant frames. The cant frames sit on **steps** cut into the **apron** of the stem. The apron is made of three pieces, the center one tapered and the two outer pieces had steps cut into them and then they were layered together to complete the apron. The stem **deadwood** sits on top of the apron.

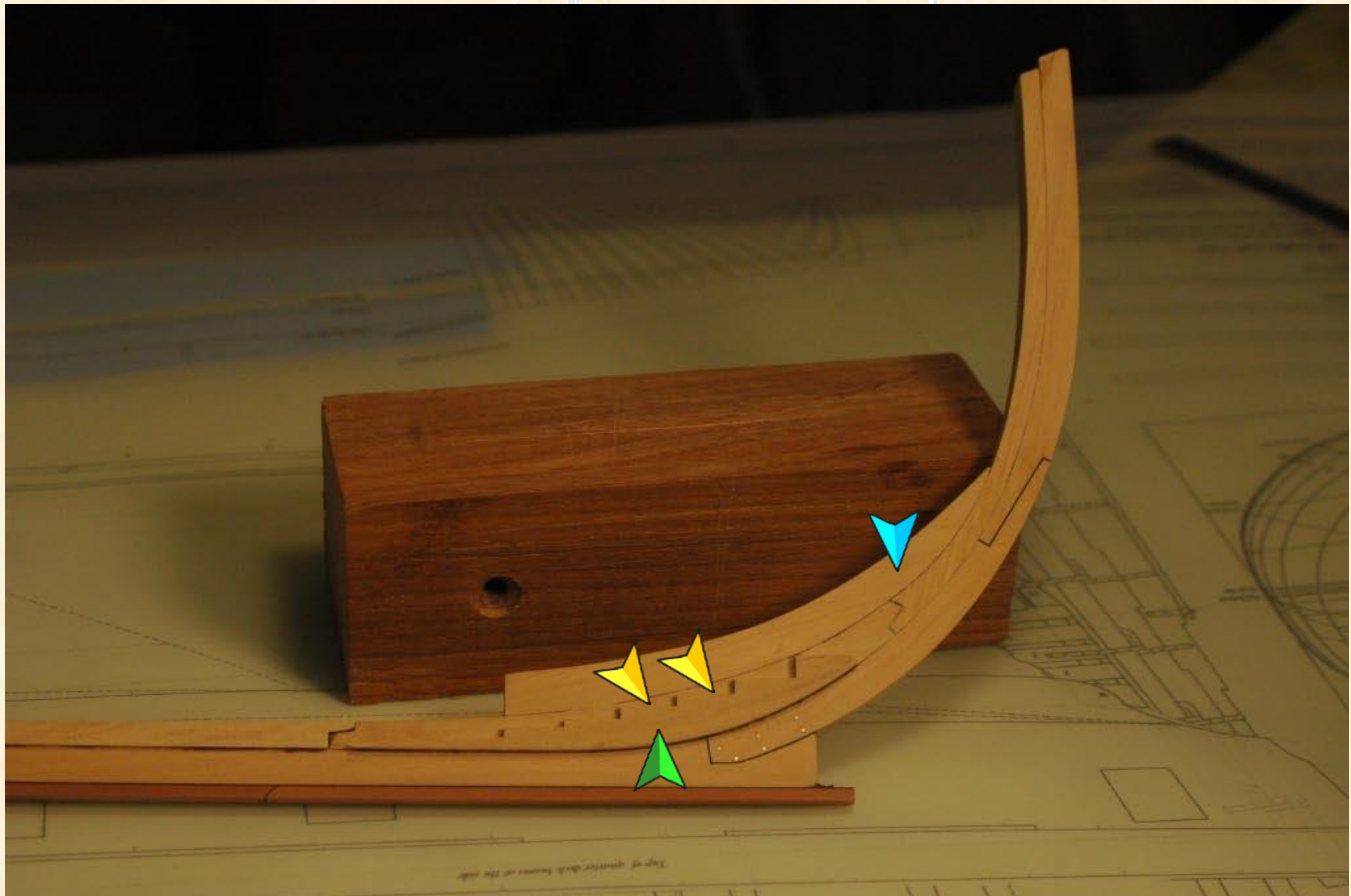

Figure 18 — stem with deadwood and apron in place

Installing the Fore Hawse Timbers and Cant Frames

Finally, I could start to assemble the hawse timbers and cant frames to the keel.

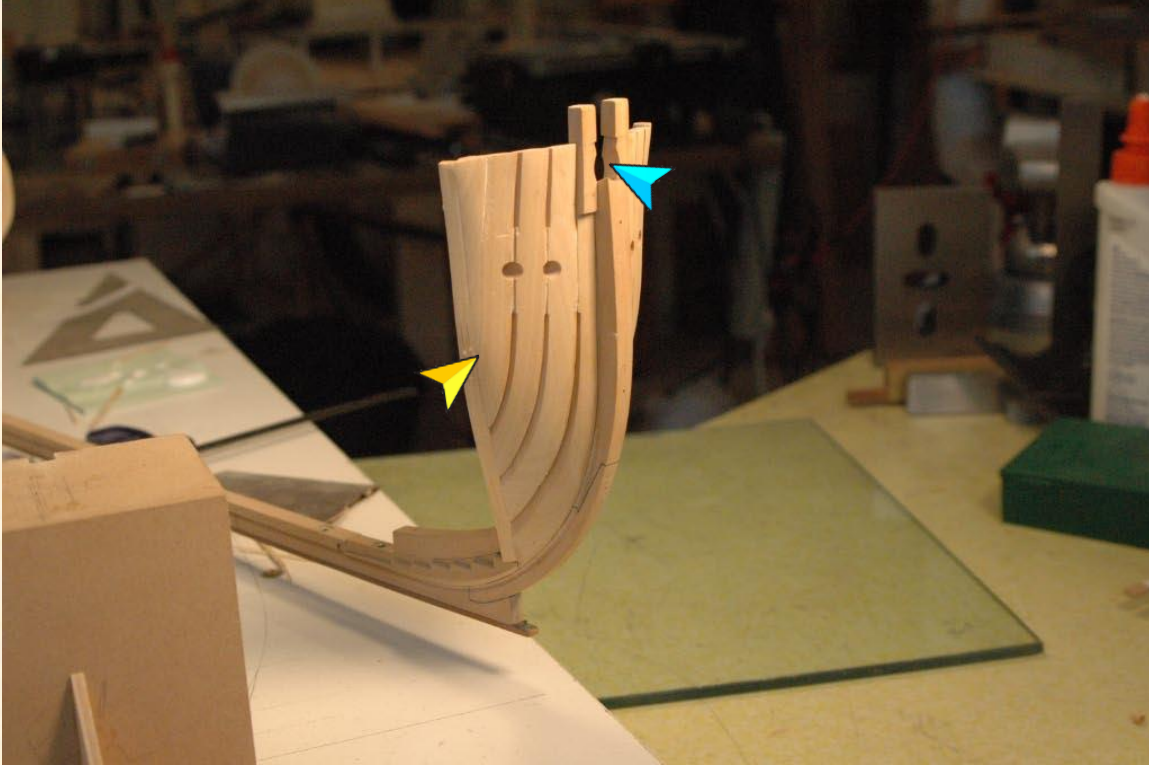

Figure 19 — hawse timbers and first cant frame in place

Note that some **fairing** has been done and there is a **notch and hole** for the bowsprit in the two bollard timbers right at the stem. More about that later.



Figure 20 — all forward cant frames installed

The cant frames sit in the steps in pairs. The increasing angle of the foot makes them fan out to form the curved bow of the ship.

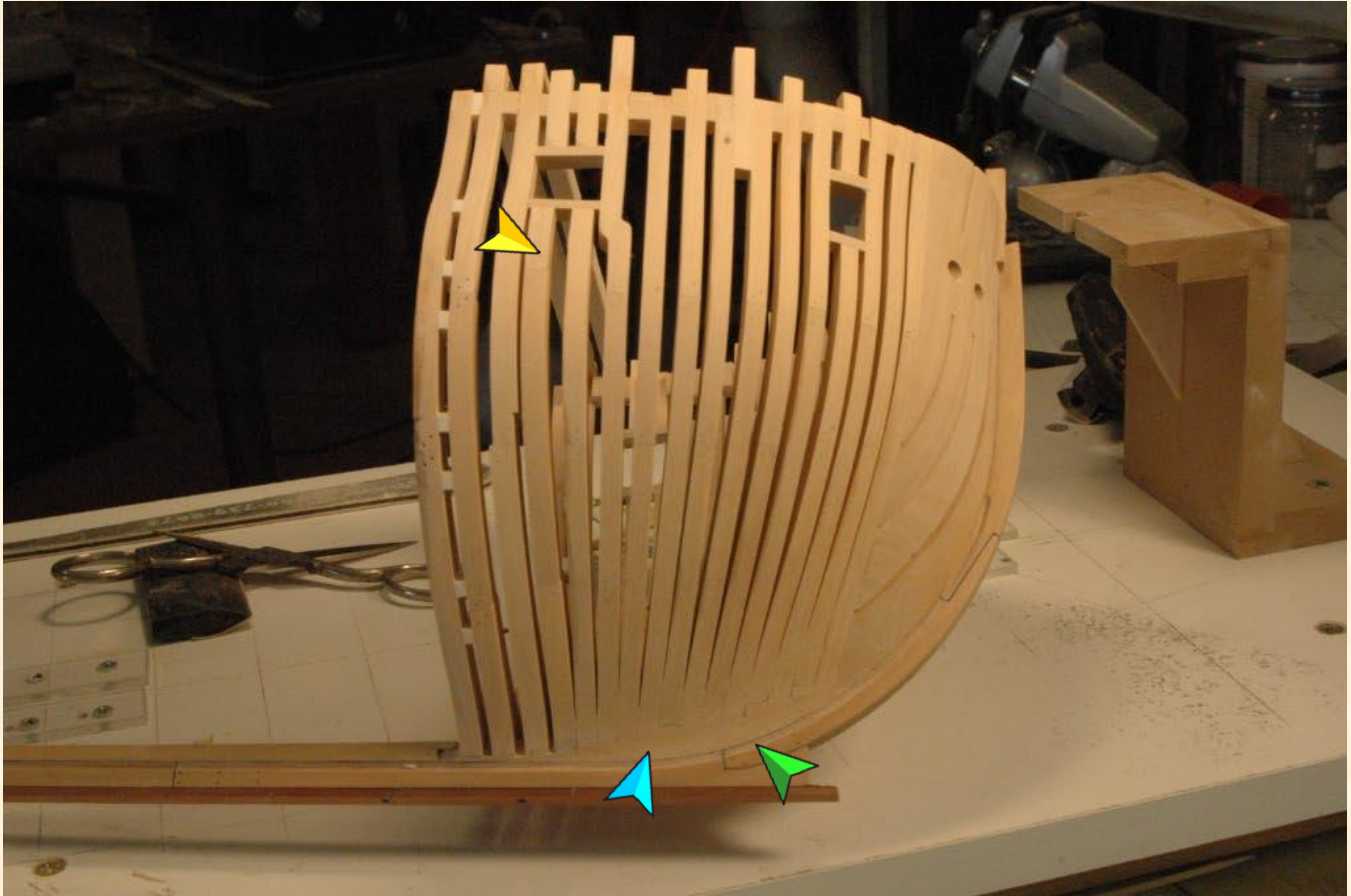

Figure 21 — the first of the square frames are installed and the fairing has been completed.

Note how the apron has been faired into the keel to form the rabbet. This was accomplished by careful cutting with a chisel.

The Bollard Timbers

The bowsprit fits between the two bollard timbers and sits on top of the stem. The hole it passes through is at an angle. To make the hole the right size and at the correct angle a long brass tube of a diameter 1 thickness of sandpaper less than the diameter of the bowsprit was located at the keel so that the tube when placed at the keel and stem formed the required angle. The hole was roughed out and sanded to final size by rotating the brass tube with sandpaper glued to the outside. The notches are tapered in depth and were filed into the bollard timbers. A cross chock fits into the notches to trap the bowsprit in place.

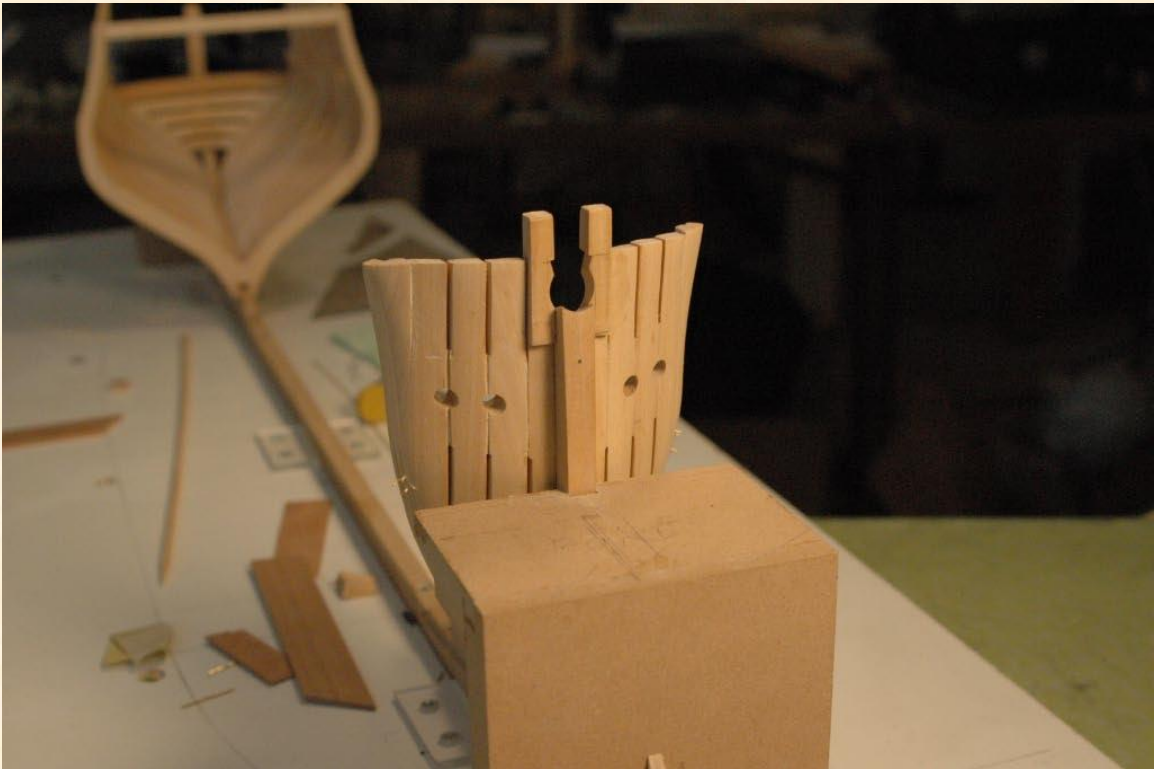

Figure 22 — hawse and bollard timbers ready for fitting the cross chock

The cross chock was very difficult to get to fit properly. It needed the radius on the bottom, and tapered, angled sides in order to fit the notches.

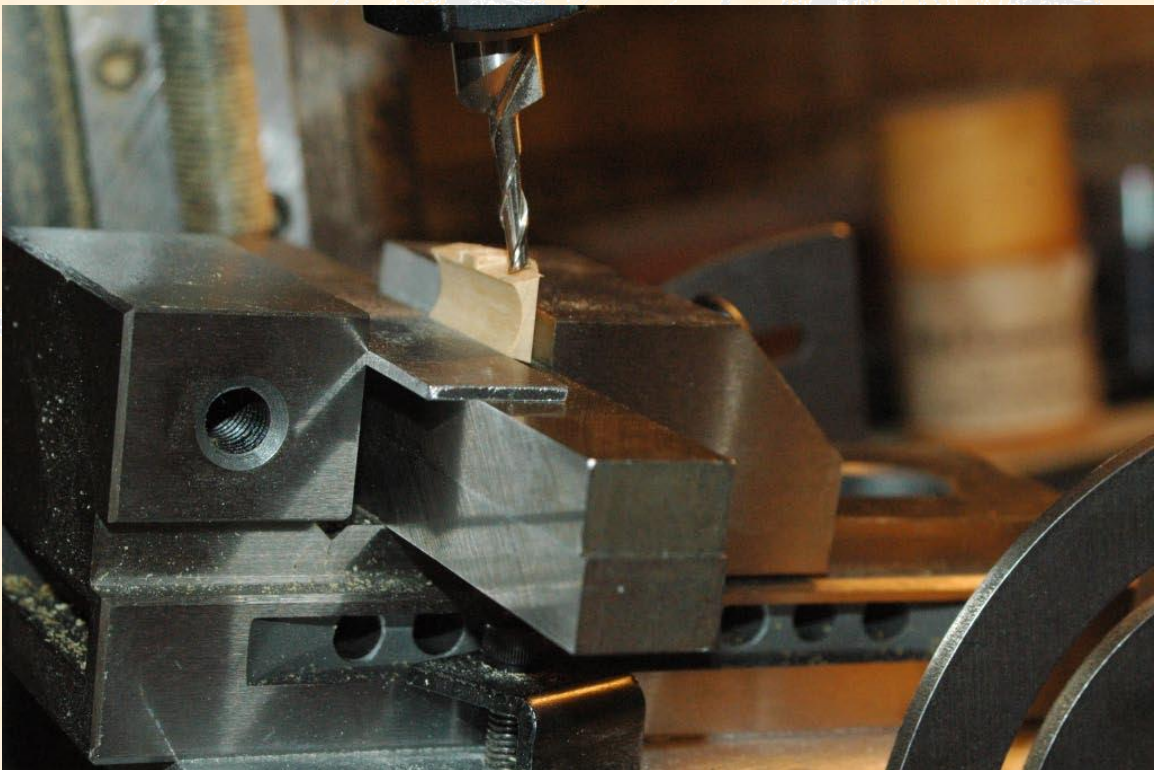

Figure 23 — machining the cross chock's angle and taper to fit the notches

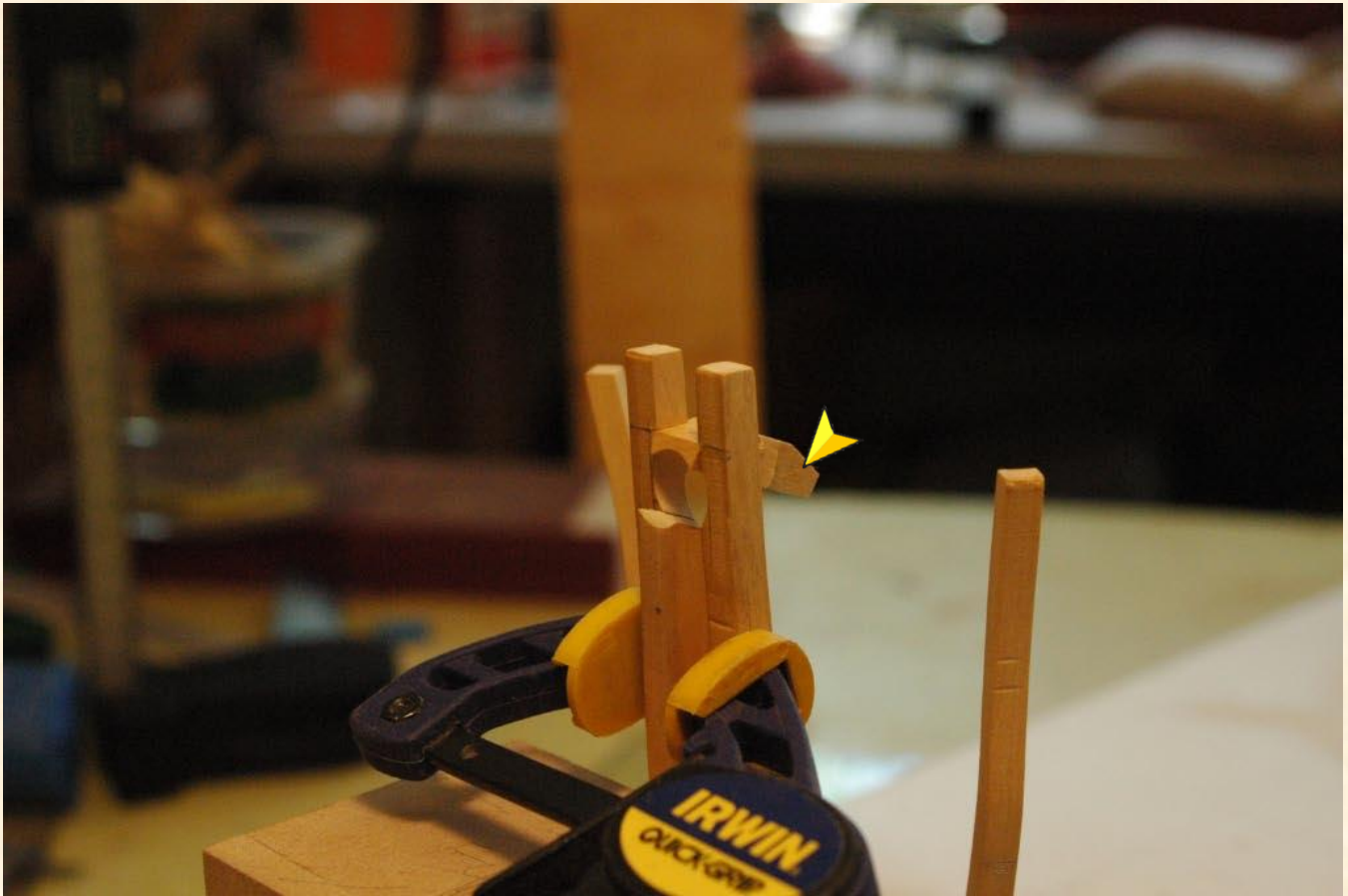
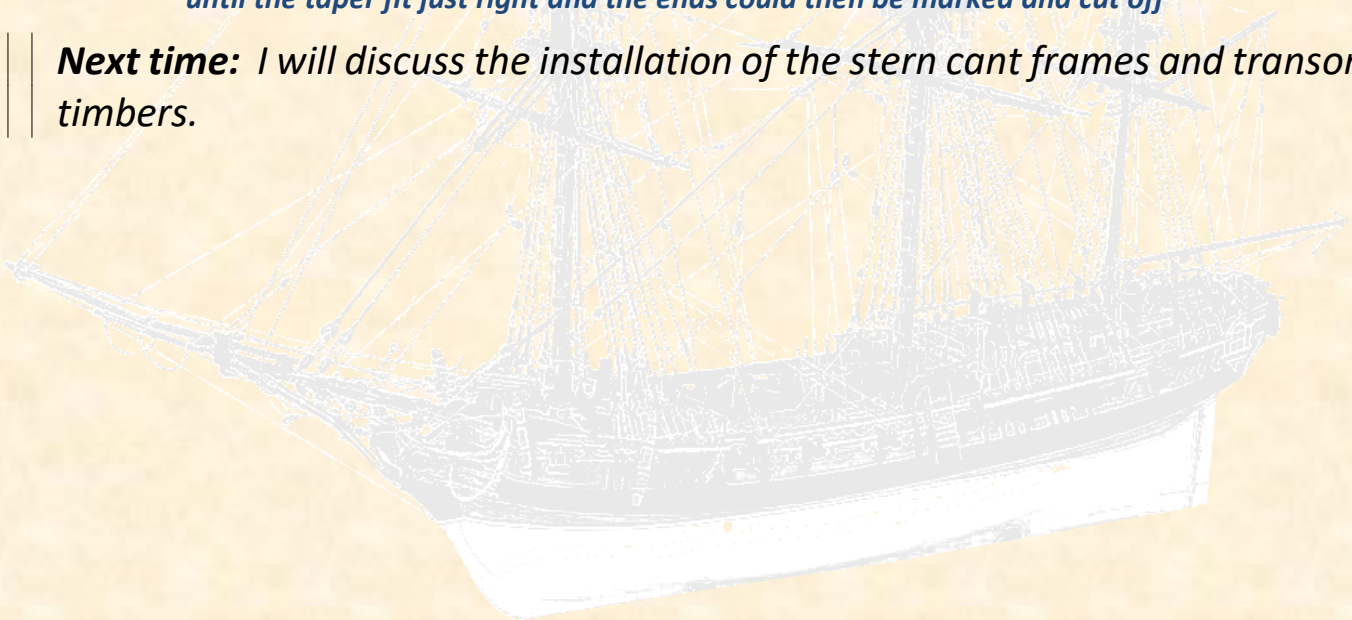

Figure 24 — the cross chock was made **extra long** so that it could be slid in until the taper fit just right and the ends could then be marked and cut off

Next time: I will discuss the installation of the stern cant frames and transom timbers.





Resources

Model shipcrafting resources originally compiled by Guild Member and master modeler Mike Lonnecker. New resources are highlighted in light red and local resources are highlighted in light green. This list appears quarterly in the Newsletter. Forward resource [suggestions](#) for addition to the list.

Company	Source For	Notes
LAUCK STREET SHIPYARD	courses, practicums, books	modeling education aids
MODEL SHIP WORLD	forums, build logs, tips, info	modeling club (very informative)
MODEL WARSHIPS	forums, build logs	for the plastic ship modeler
NAUTICAL MIND	nautical books	some European books
NAUTICAL RESEARCH GUILD	quarterly magazine	modeling research group (excellent)
SEAWATCH BOOKS	modeling books	books geared to the model builder
WOODEN SHIP MODELING	photos, videos, tips	tips for building models

Company	Source For	Notes
123 STITCH	sewing supplies	DMC cotton thread for rigging
ADMIRALTY MODELS	plans, photoetch, kits	by David Antsherl, Greg Herbert limited product line (excellent quality)
AGES OF SAIL	kits, parts	complete line of Amati kits
BLICK ART MATERIALS	wood, glue, paint, paper, stock	art materials 1844 India St, San Diego CA
BLUEJACKET SHIP CRAFTERS	kits, parts	(good quality)
BYRNES MODEL MACHINES	table saws, disk sanders	(the best)
CARVING ORNAMENTATION	carving tutorial	techniques, tools, materials for use in carvings for ship models
CINCINNATI SURGICAL	Swann-Morton blades, handles, hobby blades	surgical supplies (good selection)
CRAWFORD TOOL	screwdrivers, hex drivers	Wiha, Bondhus, Knipex tools
DEDECO	rotary tools, burrs, stones, cutoff wheels	cutting tools (big selection)
ePLASTICS (formerly RIDOUT)	plexiglass, display cases, dustcovers	plastic supplies 5535 Ruffin Rd, San Diego CA
ESSLINGER	jewelry tools, parts	watchmaker
FOREDOM	rotary tools, handpieces, accessories	flexible shaft tools
FORSTER PRODUCTS	Swiv-O-Ling vise	gunsmithing tools
FROST HARDWOOD	hardwood, veneer, glue	hardwood supplier 6565 Miramar Rd, San Diego CA
GESSWEIN	hand tools, drills, burrs, finishing materials	jewelry supplies (high quality)
GRS	supplies, ring clamp system, vises, gravers, engraving tools	jewelry tools
GYROS	cutting tools, saws, sanding disk/drums	for use in rotary style machines
HOBBYLINC	cars, plane, ship kits, paints, supplies	online hobby shop

<u>J I MORRIS</u>	miniature fasteners	specialty hardware
<u>JAPAN WOODWORKER</u>	hand tools, chisels, gouges, hand planes, accessories, sharpening stones	woodworking tools
<u>LEE VALLEY</u>	hand tools, power tools, small planes, sharpening systems	woodworking tools (high quality)
<u>LITTLE MACHINE SHOP</u>	lathes, mills, tooling, parts	benchtop machinist tools (high quality) (good prices)
<u>LOYALHANNA DOCKYARD</u>	kits, parts	mostly steel navy
<u>LUMBERYARD</u>	kits, wood, cannons	wood kits for Hahn-style scratch builds great cannon kits in ¼" and other scales
<u>MARSHALL'S HARDWARE</u>	hardware	general hardware 8423 Production Ave, San Diego CA
<u>MICRO-MARK</u>	modeling tools, hand tools, machine tools	mostly from China (large selection) (medium quality)
<u>MINI TAPS</u>	mini taps, dies, fasteners	specialty hardware
<u>MODELER'S SAWMILL</u>	milled wood strips, sheets	boxwood, cherry, Alaskan yellow cedar
<u>MODEL-EXPO</u>	kits, parts, tools	imported tools (large selection) (medium to poor quality)
<u>MODEL MOTORCARS</u>	model size nuts, bolts	motorcar kits site with miniature hardware
<u>OTTO FREI</u>	jewelry tools, GRS BenchMate, vises, Woolf tools, Freedom tools	good prices
<u>PRECISION SCALE MODEL ENGINEERING</u>	parts, materials, tools	huge selection
<u>PROXXON</u>	power hand tools, machine tools	specialty modeling tools (big selection) some machines used to be Preac
<u>RIO GRANDE</u>	jewelry supplies, files, pliers	Swiss, German, USA made (high quality)
<u>ROCKLER</u>	hand tools, power tools, wood, finishing	woodworking supplies 8199 Clairemont Mesa Blvd, San Diego CA
<u>SHERLINE MACHINES</u>	table top lathes, mills, accessories	woodworking machines (good quality) excellent variety of accessories 3235 Executive Ridge, Vista CA
<u>SILVER SUPPLIES</u>	silver solder	jewelry supplies
<u>SWANN-MORTON</u>	scalpels, blades	(the best)
<u>TAIG LATHE</u>	table top lathes, mills, accessories	uses Sherline accessories similar in size to Sherline but more robust (excellent quality)
<u>TH&H</u>	domestic wood, trim, finishing	wood supplies 8849 Complex Dr, San Diego CA
<u>THUNDERBIRD SUPPLY</u>	tools, metal, beads, solutions	craft supply
<u>TRAVERS</u>	drills, end mills	machine shop tools
<u>UMM-USA</u>	kits, tools, accessories, detailing	hobby shop cars, aircraft, armor, ships, subs
<u>UTOPIA TOOLS</u>	jewelry tools, hobby supplies	wide range
<u>WELD FABULOUS</u>	Smith little torch	welding supplies
<u>WOOD DATABASE</u>	wood information, color, hardness	wood compendium



Alex Roel

San Diego Bay, July 4 2019, 8:20pm

Thanks to our sponsor, the Maritime Museum of San Diego, the San Diego Ship Modelers Guild is fortunate to call not only San Diego Bay our home, but also the steam ferry BERKELEY, part of the Museum's fleet tied up on San Diego's Embarcadero.

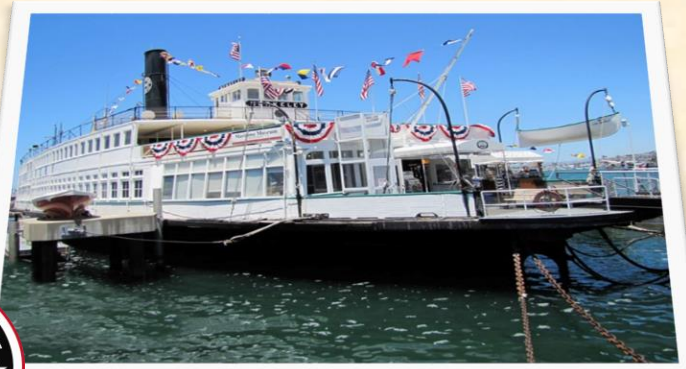



The Bitter End

Mission Statement



The [San Diego Ship Modelers Guild](#) is dedicated to the preservation and enhancement of the craft of building scale ship models and to providing a forum for the exchange of ideas, information, skills, and techniques.

Maritime Museum of San Diego



The Guild encourages all Members to join and maintain an annual membership in the [Maritime Museum of San Diego](#). As our sponsor, the MMSD provides the Guild space aboard the steam ferry BERKELEY to hold monthly meetings; allows us to work in, store supplies, and maintain the Museum Model Shop; and annually awards Guild entrants ribbons and cash prizes for the Design In Wood competition at the San Diego County Fair.

Nautical Research Guild



The Guild also encourages all Members to join and maintain an annual membership in the [Nautical Research Guild](#). As a chartered Chapter Club, the NRG accords certain benefits, privileges, and protections to our Guild.

Piracy in Model Shipcrafting

Although there is no single, agreed-upon definition of what constitutes "piracy", the use of another's intellectual or physical property without recompense is the basis for any working definition. Unfortunately, this is an issue that affects our craft: be scrupulous and avoid purchasing pirated kits or materials.



Our Founders

The Guild was founded in 1971 by Bob Wright and Russ Merrill in collaboration with Ken Reynard, Captain of the barque STAR OF INDIA.